

# User Manual

# Tuning solutions



Features

- 1.Operating System:Android 13 Qualcomm 8-core 8+128GB.
- 2.Keep original car functions.
- 3.Support Wireless Carplay/Androidauto.
- 4.Support voice input ( like Siri or Google voice assistant).
- 5.Aftermarket Rear View AHD Camera and DAB+ (optional).
- 6.Built-in GPS Navigation system,Support iGo and waze etc.
- 7.Built in WiFi and support 4G LTE Card.
- 8.Support rear view,reverse radar,and rear track.
- 9. Built-in Bluetooth (Hands-Free Calling and Audio Streaming).
- 10.Built in microphone.
- 11.Language:support English/Russian/French/German/Spanish/Italian/Arabic/Portuguese/Turkish/Hebrew,etc.

Accessories

Mercedes Benz NTG 4.0 system

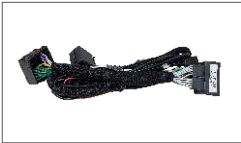

1\* CAN Power cable



1\*AUX cable



1\* GPS Antenna



1\* AMI cable



1\* Nut accessories

Mercedes Benz NTG 4.5 system



1\* CAN Power cable



1\*AUX cable



1\* GPS Antenna



1\* LVDS adapter cable



1\* AMI cable



1\* Nut accessories

Mercedes Benz NTG 5.0 system



1\* CAN Power cable



1\*AUX cable



1\* GPS Antenna

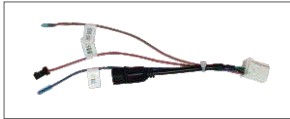

1\* LVDS adapter cable



1\* AMI cable



1\* Nut accessories

Compatible models

Host system	Model/Specification
NTG3.0	Mercedes-Benz S-Class W211_2006-2008(Only 10.25 inches)
NTG4.0	Mercedes-Benz C-Class W204_2007-2010
NTG4.0	Mercedes-Benz E-Class 4-door W212_2008-2011
NTG4.0	Mercedes-Benz GLK_X204_2008-2012
NTG3.5	Mercedes-Benz S-Class W211_2009-2012(Only 10.25 inches)
NTG4.0	Mercedes-Benz SLK_R171_2010-2012
NTG4.0	Mercedes-Benz CLS_C / Mercedes-Benz W218_2010-2012(W207)
NTG4.0	Mercedes-Benz B-Class W245_2011-2012 (Left peptide)
NTG4.5	Mercedes-Benz C-Class C204_2011-2014
NTG4.5	Mercedes-Benz C-Class S / Mercedes-Benz W204_2011-2014 (Right peptide)
NTG4.5	Mercedes-Benz E-Class 4-door W212/Mercedes-Benz E-Class 2-door W212_2012-2013

Host system	Model/Specification
NTG4.5	Mercedes-Benz SLK_R172_2013-2014
NTG4.5	Mercedes-Benz B-Class W246_2013-2014 （Right peptide）
NTG4.5	Mercedes-Benz B-Class W246_2013-2014 （Left peptide）
NTG4.5	Mercedes-Benz GLK_X204 / CLC_C / W218 / GLA_X156 / A-Class W176 / G-Class_2013-2015
NTG5.0	Mercedes-Benz E-Class 4-door (W212) / Mercedes-Benz E-Class 2-door 2014-2015
NTG5.0	Mercedes-Benz C-Class W205 / Mercedes-Benz V-Class / Mercedes-Benz GLC_2015-2018
NTG5.0	Mercedes-Benz SLK_R172_2015-2019
NTG5.0	Mercedes-Benz B-Class W246_2015-2019 （Left peptide）
NTG5.0	Mercedes-Benz B-Class W246_2015-2019 （Right peptide）
NTG5.0	Mercedes-Benz GLA_X156 / Mercedes-Benz A-Class W176 / Mercedes-Benz G-Class_2016-2018
NTG5.0	Mercedes-Benz CLS_C / Mercedes-Benz W218_2016-2019

Bluetooth Connection

- 1. Click 'Bluetooth', enter Bluetooth connection interface
- 2. Click 'Search' to find the BT signal of your phone
- 3. Click the BT name of your phone, then a prompt to enter the Bluetooth password will be displayed on the phone. Input password, click 'OK'
- 4. Bluetooth connection is successful.

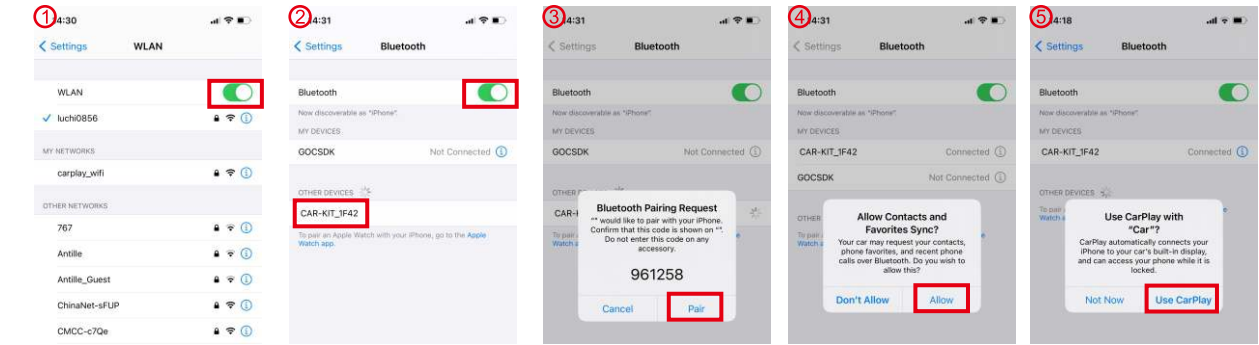

Mirrorlink Connection

Wireless Apple Carplay and Android Auto

Turn on Bluetooth and WiFi in the phone settings.

Search for the Bluetooth name of the Android system in the Bluetooth interface. You can pair carplay or Android auto directly.

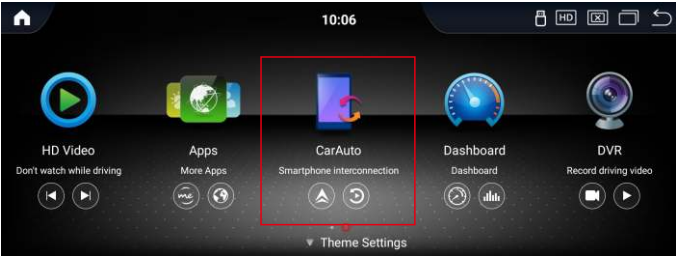

AirPlay and Auto link

Connect the screen to the phone's hotspot and use AirPlay and auto link screen mirroring functions.

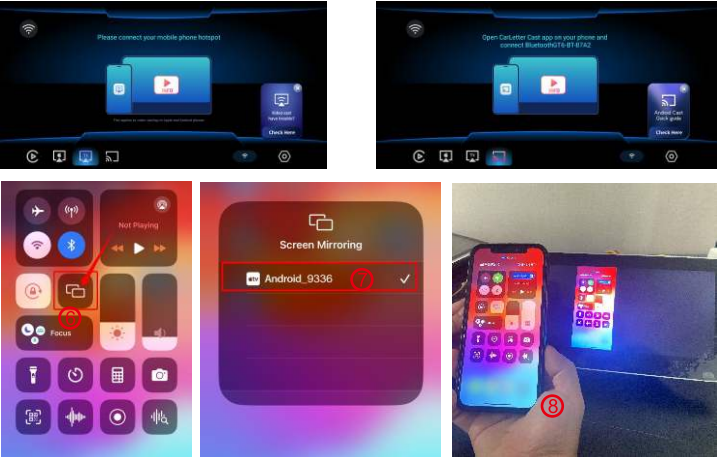

## Android system main interface

- 1.Support installation of third-party map software:Nexit, Google Maps, Bing Maps, MapQuest, Here WeGo, Waze, IGO, etc.
- 2.Support playback of HD videos:Supported video formats: wmv, asf, asx,rm, rmvb, mp4,3gp.mov, m4v, avi, dat, mkv, flv, vob,AVI, WMV, etc.
- 3.Support music formats:WAV, FLAC, APE, ALAC, WavPack (WV), MP3, AAC, Ogg Vorbis, Opus, etc.



(UI Display:Main menu)

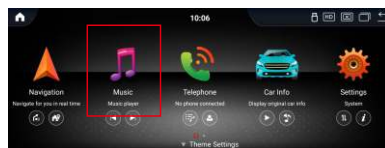
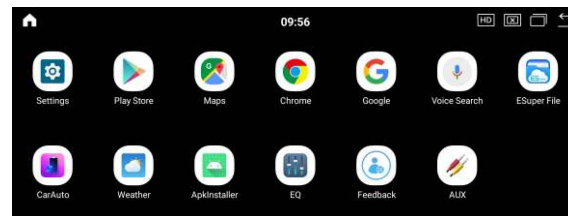

(UI Display:Map)



(UI Display:Music)

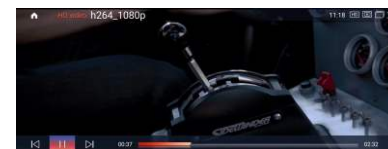

(UI Display:HD Video)

## Setup Instructions

**Reverse Camera Mirrored:** Turn off this option if reversing image display mirror.

**Disable video when driving:**ON means that the video cannot be played while driving.

**Reverse track:**Turn on/off reversing tracking line.



**Camera selection:** for reverse camera selection,

connect pink cable, select 'Afermarket camera'

connect brown cable, select '360 camera'

use original camera, select 'Original camera'

**Brightness:** Adjust the brightness of the screen.





**Volume:** Adjust the volume in Android system.

**Time synchronization:**Default to Android time.The time will be updated synchronously according to GPS .

**Time system:**Set the time to display in 12-hour or 24-hour format.



**Automatic Brightness:**

Width Lamp control: the display automatically dims after turning on the headlights.

Close:turn off auto dimming.

**Unit selection:**set the speed unit of the dashboard.

**Car without OEM monitor:**if the car without OEM screen,turn on this option,a clock will be displayed when switching to OEM system.

**AUX switching modes:**

Automatic: the sound can be switched automatically when switching two systems.

Manual:when switching to another system,the sound will turn off.

**AUX auto switching:**Head unit selection.Default to Harman,no need to change.

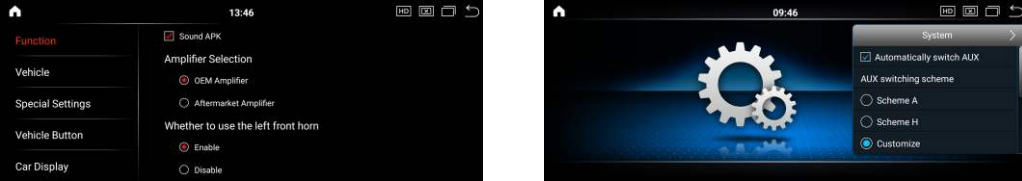

**Knob Type:**for the iDrive can't work normally on Android system,switch iDrive A/B,then restart.

**Door settings/Number of doors:**Match the original car information.

**Speedometer selection:**Set maximum speed display.

**Gear selection:**car with auto gear,select 'Automatic';car with manual gear,select 'Manual'.

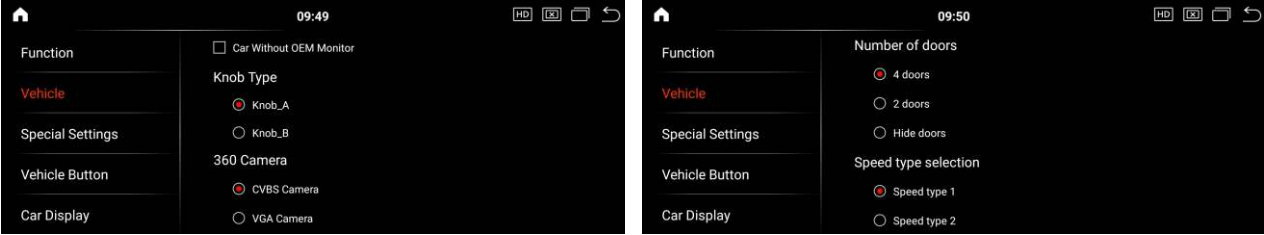

**Car display:**set the original car system display size.If the OEM system can't display in full screen,select the same size as the original car screen,

nothing to do with the car model.

**UI Selection:**select UI you want to set,change the UI display on Android system.

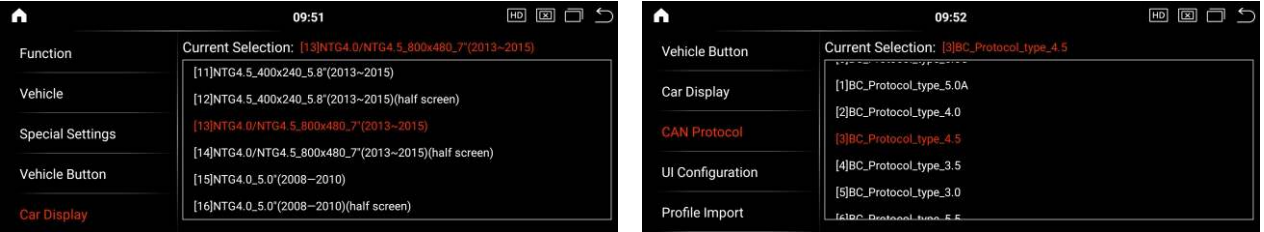

Specification

Technical	
CPU	Snapdragon 665 (Sm6125)
CPU cores	8 core Kryo 260 ,11nm LPP process
Main frequency	2GHz +1.8GHz
Android	13
Resolution	1920*720
RAM/ROM	8GB+128GB
Audio output	1 channel analog stereo audio output;2 channel I2S
Video input	1 channel MIPI-DSI, 4 Lanes (Max. 2520*1080@60fps)

Mechanical	
Operating temperature	-30℃~+75 ℃
Storage temperature	-40℃~ +85℃
Operating humidity	45%~80%RH
Storage humidity	30%~90%RH

The wiring method of the camera

Automatic transmission

- ① Select the rear camera in the camera setting
- ② Connect the pink wire (cam power) to the camera
- ③ Connect the trunk camera power wire together  
(connect these two red cables together)

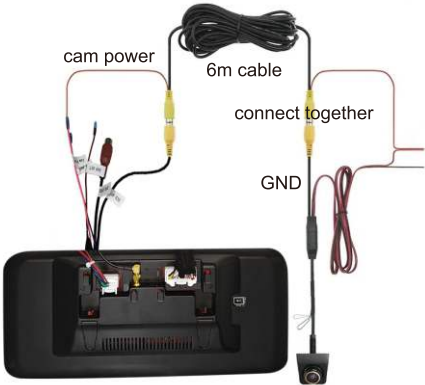
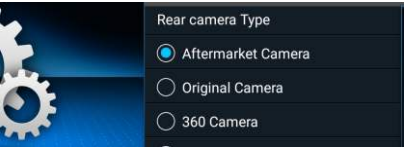

Manual transmission

- ① Select the 360 camera in the camera setting
- ② Connect the brown wire (360 DET)
- ③ Connect the trunk camera power wire to the reverse lamp 12V  
(some cars need to connect a rectifier)

The original car does not reverse image should also be so connected like this.

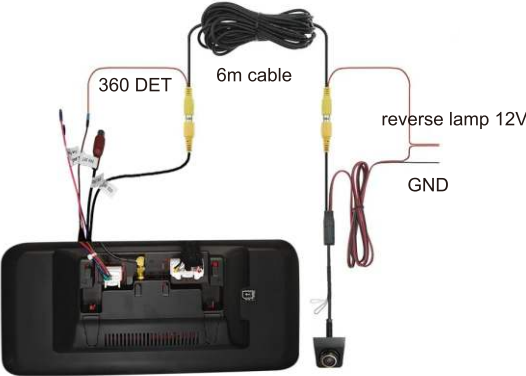
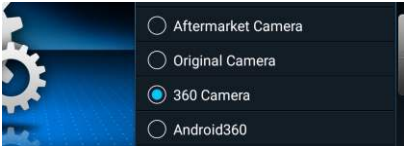



## Benz NTG4.0

### Cables connection diagram

- [1]:DVR video head
- [2]:Rear video head
- [3]:USB 1
- [4]:USB 2
- [5]:Power cable
- [6]:Power cable
- [7]:AMI cable
- [8]:AUX detection cable
- [9]:Power cable for camera
- [10]:360 detection cable
- [11]:Power cable for camera
- [12]:AUX cable

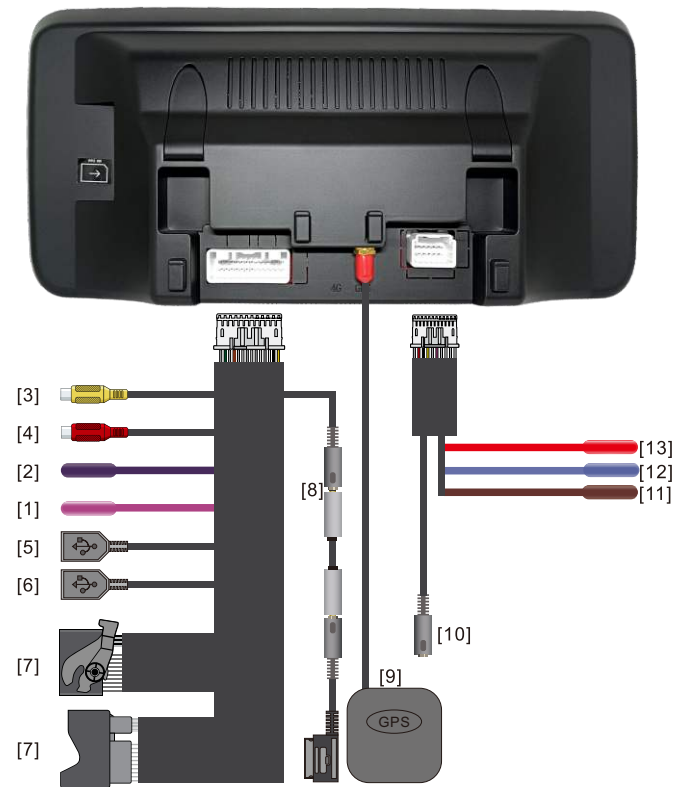

## Benz NTG4.5

### Cables connection diagram

- [1]: AUX detection cable
- [2]:Power cable for camera
- [3]:Rear video head
- [4]:DVR video head
- [5]:USB 1
- [6]:USB 2
- [7]:Power cable
- [8]:AMI cable
- [9]:GPS antenna
- [10]:LVDs cable
- [11]:360 detection cable
- [12]:DVR IR
- [13]:Power 12V



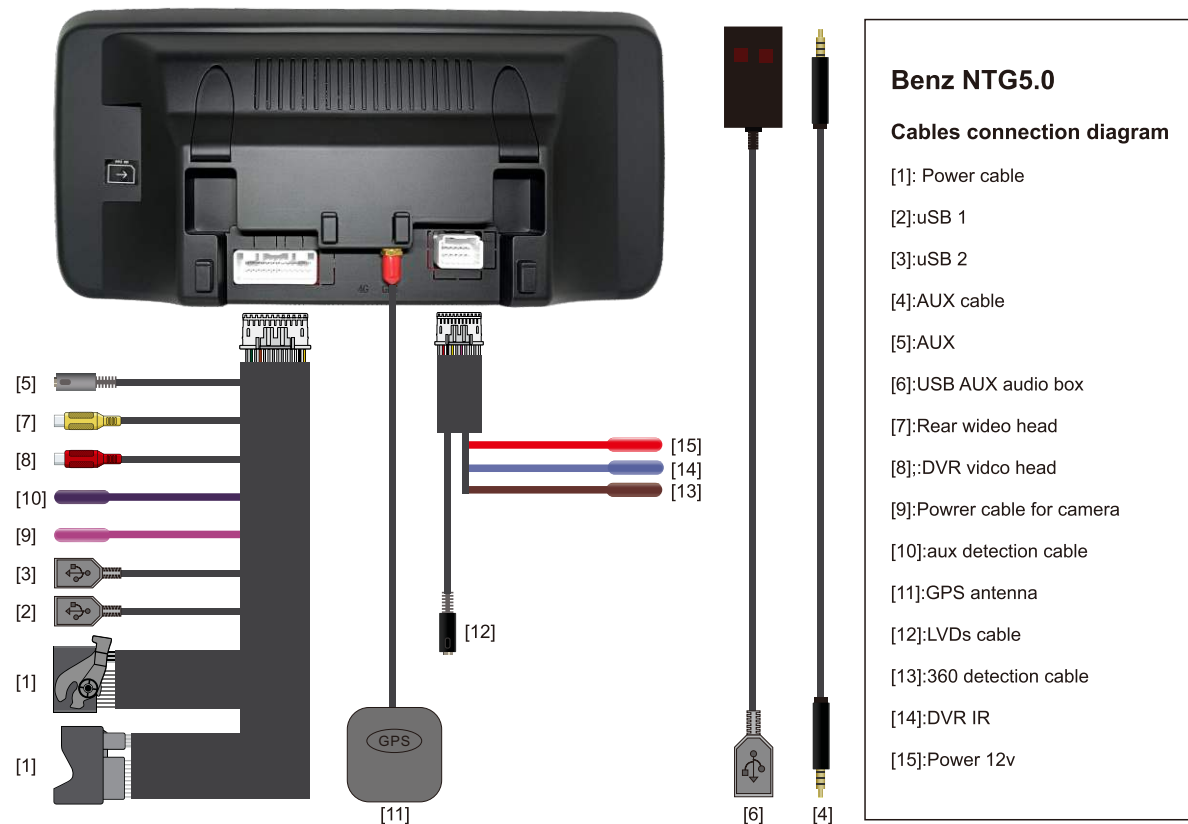

## Automatically switch AUX function settings

### NTG4.5, NTG4.7 systems

Only for the original car with AUX function of the system, such as NTG4.5, NTG4.7 System

1. into the factory settings → car configuration → AUX automatic switching scheme, select“Other”.



2. Go back to the home screen and enter the settings screen → system settings → the location of the original AUX item.



according to the original car AUX specific position adjustment

3.The“Original car AUX item location 1” is set to the original car“Audio” icon location, if in Item 2, then set to 2, and so on as shown in the following figure, the NTG4.5/NTG4.7 system is generally in item 1.



4. “Original car AUX entry position 2” is the“AUX” location under the original car audio submenu, set to 6 if at entry 6.



**The NTG4.0 system**

NTG4.0 does not support automatic switching.

**NTG5.0 system**

Mercedes-benz NTG5.0 system does not have AUX function, need to use external USB-AUX audio converter, is a USB device.

1.After plugging the USB-AUX device into the car's USB port, the host recognizes the USBsources device, as shown below:



Mercedes-benz media selection interface

2.Select to enter the USBsources interface, as shown below:

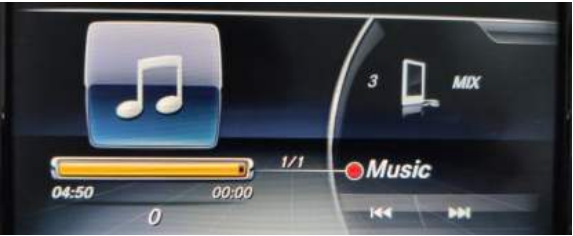

The USBsources interface

3.Long press the COMMAND asterisk“\*” key to set the shortcut key, enter the main screen as follows, from the first position to the number of“1” item, the USB audio device shortcut key placed in the main screen of the nth item, n is the setting value for“Original AUX key location 1” in Android settings.



Mercedes-benz NTG5.0 main interface diagram



Command image

## Automatically switch AUX function settings

### direct activation

This feature only supports NTG4.5/4.7 machines, go to factory settings → on-board configuration→ Mercedes-benz AUX activation

When the ACC of the original car is turned on and the CD host is turned on, the original car CD host will automatically restart after checking this option. At this time, you can return to the original car interface to check the restart status. After the restart is completed, under audio, there will be a "Aux" option, as shown below

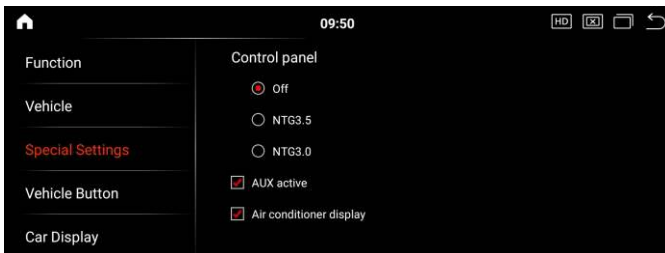

## Enter Manual activation in factory mode

Some models of Mercedes-benz can not directly activate AUX, need to manually enter the host of the project mode selection;

2, enter the project mode method: At the same time press: the number "1" + "#" + "Phone answer button", a long press of about

8s will automatically enter the engineering mode interface as shown below

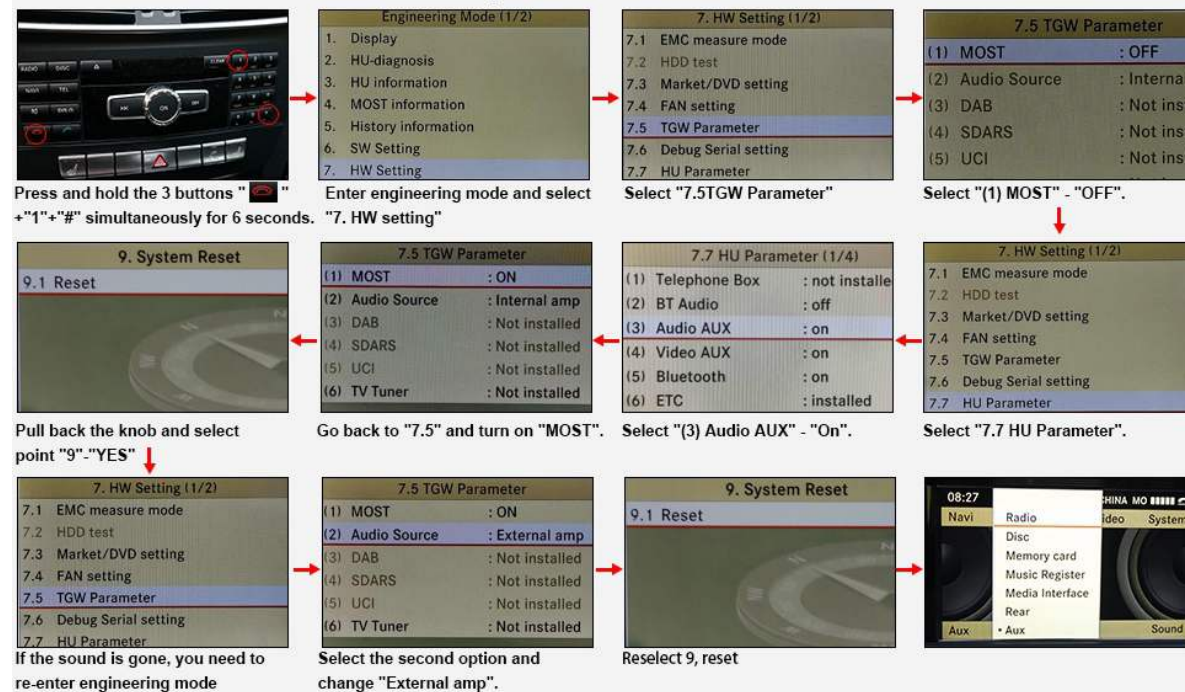

After activating AUX, go back to the Engineering Mode main screen, turn to page 2 and select item 9 to restart the system.

Note: The Menu selects the COMMAND knob, and the page-turning operation uses the knob's up and down joystick control.

FAQ

1. Reverse interface not working

Enter the factory settings-car configuration-- gear selection, "Automatic" and"Manual" is actually the choice of Gear 1 and 2; If both options are not cut back, it may be a special model or did not collect data, do not support reverse, can only use 360 detection reverse

2. The Knob doesn’t work on the Android interface.

Go to the factory settings, the on-board configuration, and switch from automatic to manual, then switch back to the original car interface, go back to Android (this setting doesn't necessarily make the knob work)

3. The door display is wrong, show 2 doors

Go to the factory settings→ can protocol selection, according to the corresponding model selection protocol

4. The android interface keeps popping up with air-conditioning refresh screens or air-conditioning information displayed incorrectly

Enter the factory settings→can protocol selection, according to the corresponding vehicle selection protocol

5.①Mercedes s-class screen side key panel individual keys invalid

Enter the factory settings→ can protocol selection, according to the corresponding model selection protocol NTG30/NTG35

②The knob on the screen-side key panel of the s-class Mercedes-benz has no effect

Enter the factory setting→on-board configuration→Knob Type; select a or B

6. The handbrake icon in the android digital instrument does not show or does not show the right problem

Go into the factory settings→ can protocol selection, according to the corresponding model selection protocol

7. Enter the factory settings-car configuration-steering wheel trajectory selection 8, voice keys can not be used

Enter the factory settings-can protocol selection, according to the corresponding vehicle model selection protocol

Can Protocol selection

Protocol description (If the protocols do not match, there will be problems with the Android air conditioner display)

Benz_Protocol_type_5.0C	NTG5.0 such as Class C, GLC, etc.
Benz_Protocol_type_5.0A	NTG5.1 such as Class A, class B, etc.
Benz_Protocol_type_4.0	NTG4.0 platform, years 08-10 LVDS 10PIN interface
Benz_Protocol_type_4.5	NTG4.5 platform, years 13-15 LVDS 4PIN round interface
Benz_Protocol_type_3.5	NTG3.5 platform, year 06-14 is generally Mercedes-benz s-class
Benz_Protocol_type_5.5	Mercedes-benz HU5.5 agreement 19-so far

Screen parameter selection instructions

[01] GLA220(16 to date)	Not yet
[02] GLA220(16 so far)(half screen)	
[03] NTG55/6(19 to date)	The 19-model mercedes-benz Hu5.5/6.0 system does not support half-screen for the time being
[04] NTG55/6(19 so far)(half screen)	
[05] NTG5.0 8-inch screen (14 so far)	After 2014 NTG5.0 systems, such as the c-class e-class, the original car displayed as an 8-inch screen model
[06] NTG5.0 8-inch screen (14 so far)(half screen)	
[07] NTG5.0 7-inch screen (16 so far)	After 2014 GLA, GLC, c-class, e-class, the original display for the 7-INCH model
[08] NTG5.0 7-inch screen (16 so far)(half screen)	
[09]GLA200_700x200	Not yet
[10]GLA200_700x200(half screen)	
[11] NTG4.0 400*200 5 inch screen (13-15)	2013-2015 NTG4.5 system, such as GLA, B series, the original car display is 5.8 inches
[12] NTG4.0 400*200 5 inch screen (13-15)(half screen)	

[13] NTG4.0/NTG4.5 800*480 7 inch screen (13-15)	2013-2015 NTG4.5 system, such as GLK, ML, E series, the original car display for 7-inch screen
[14] NTG4.0/NTG4.5 800*480 7 inch screen (13-15)(half screen)	
[15] NTG4.0 5-inch screen (08-10)	Before 2012, the original Mercedes had a 5-inch screen
[16] NTG4.0 5-inch screen (08-10)(half screen)	
[17] NTG4.7 800*480 7-inch screen (08-10)	After 2014 NTG5.0 systems, such as the c-class e-class, the original car displayed as an 8-inch screen model
[18] NTG4.7 800*480 7-inch screen (08-10) (half screen)	
[19]S350_800x480 7-inch screen (10)	Mercedes-benz s-class by 2014
[20]S350_800x480 7-inch screen (10) (half screen)	

Mercedes 5.5

After loading, you need to update the latest factory configuration file, CAN agreement select“Benz”, otherwise reverse, control keys, doors, air conditioning and other information will be invalid, screen parameters select“NTG55/6”.